

X45

FALL TUNE-UP

Proheat X45 Fall Check/Service Procedure

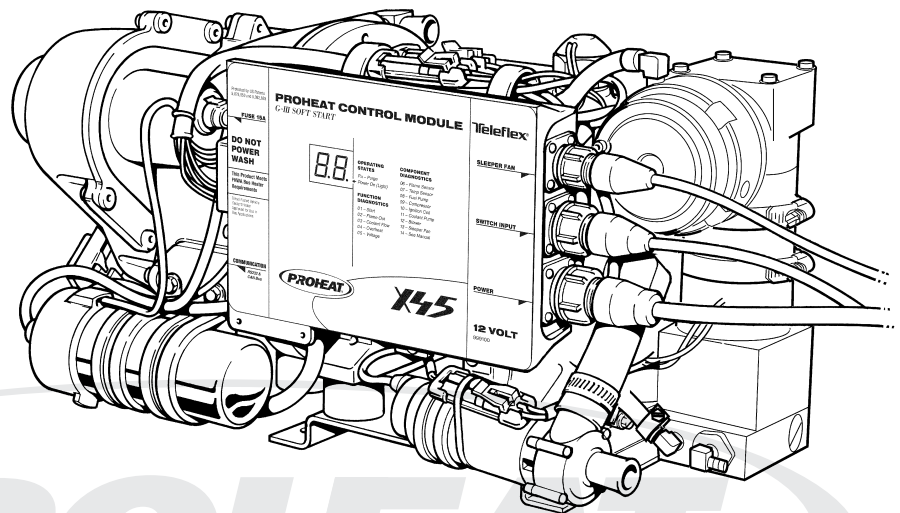

Your **PROHEAT** has been designed to operate with a minimum of maintenance. To ensure the efficient operation of your heater a **FALL TUNE-UP** is strongly recommended to be performed each year.

NOTICE

A higher duty cycle may require a more frequent maintenance schedule.

Proper maintenance will result in the following benefits:

- Maximum heat transfer to the coolant
- Minimum battery power draw
- Long term cost savings
- Increased reliability

1 Clean Heater Enclosure

- Remove the heater enclosure cover.
- Clean any accumulated debris or dust from the components.
- Blow out the compartment with compressed air.
- **Do not pressure wash.**
- Make sure the opening around the exhaust pipe is clear.
- Visually inspect all the components for wear or damage.

**CHECK COMBUSTION
AIR INLET FOR
RESTRICTIONS.
CLEAN AS REQUIRED**

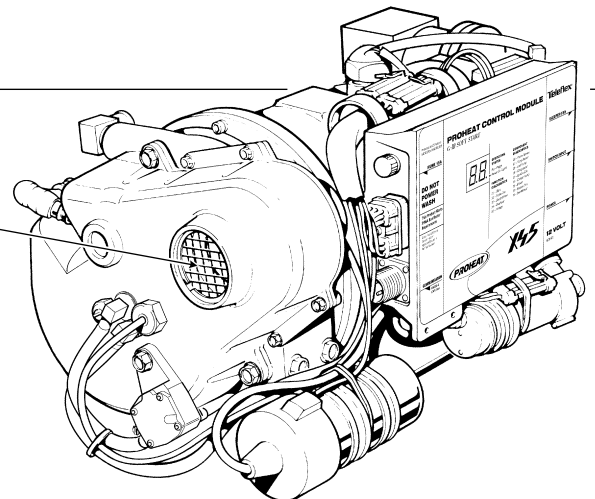

2 Check Exhaust System

- Make sure the exhaust pipe is fully installed and vents outside if the engine compartment.
- Check the pipe for dents, restrictions or severely corroded areas.
- Ensure exhaust pipe clamps are tight.
- Replace the exhaust pipe and clamps if necessary.

3 Check Heat Exchanger

- To maintain optimum heat output, clean any combustion deposits that may have accumulated on the heat exchanger fins.
- Remove the fan end assembly and combustion tube to access the inside of the heat exchanger.
- Ensure exhaust pipe is clean and free from restriction.
- Use a wire brush to loosen the deposits and a vacuum to remove debris.
- Torque securing screws to 25 in. lbs. (2.9 Nm).

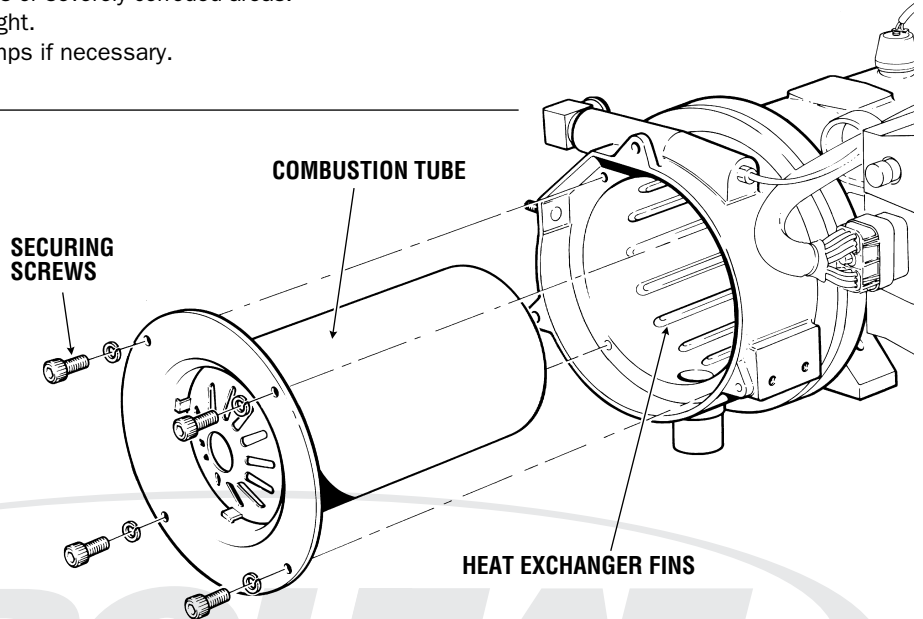

4 Check Cooling System

- Check coolant pump, all coolant hoses and connections for signs of leakage or damage.
- Repair or replace as required.

5 Check Batteries

- Check the condition of batteries and the power connections. The heater will not function properly with weak batteries or corroded connections.
- **Note** For best results load test each battery individually.

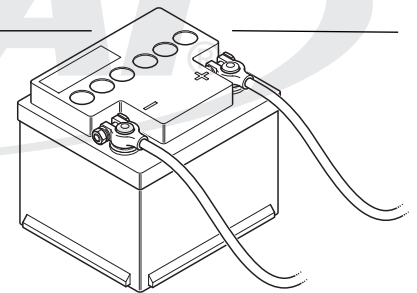

6 Check Fuel System

- Check Fuel Pick-Up tube and line to the heater for damage, cracks from aging or leakage.
- Check Internal Fuel and Air hoses for damage and cracks from aging or leakage.
- Check Fuel Regulator for damage or leakage.
- Ensure all Fuel and Air line clamps are secure.

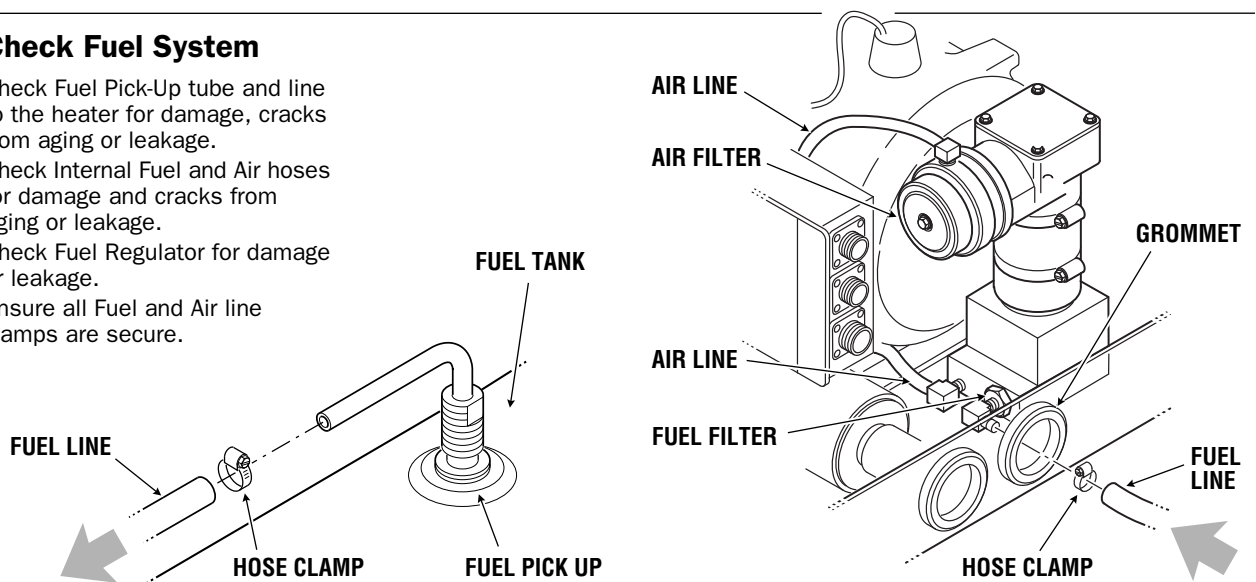

7 Check Fuel Filter

- Remove and inspect filter. Replace as necessary.

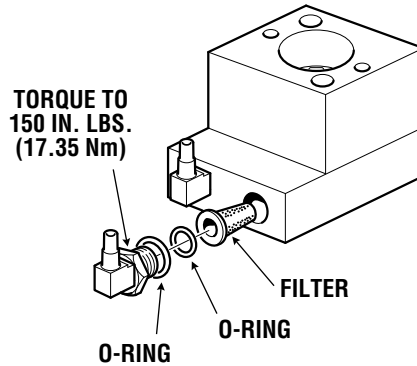

8 Clean Nozzle

- Remove and install Nozzle as per Service Manual 925830. Torque to 150 in. lbs. (17.35 Nm).
- To properly clean the nozzle use a degreaser/cleaner or carburetor cleaner in a spray can. This will wash any dirt out and leave no residue. When using compressed air, blow into the nozzle orifice **from the head end ONLY**.

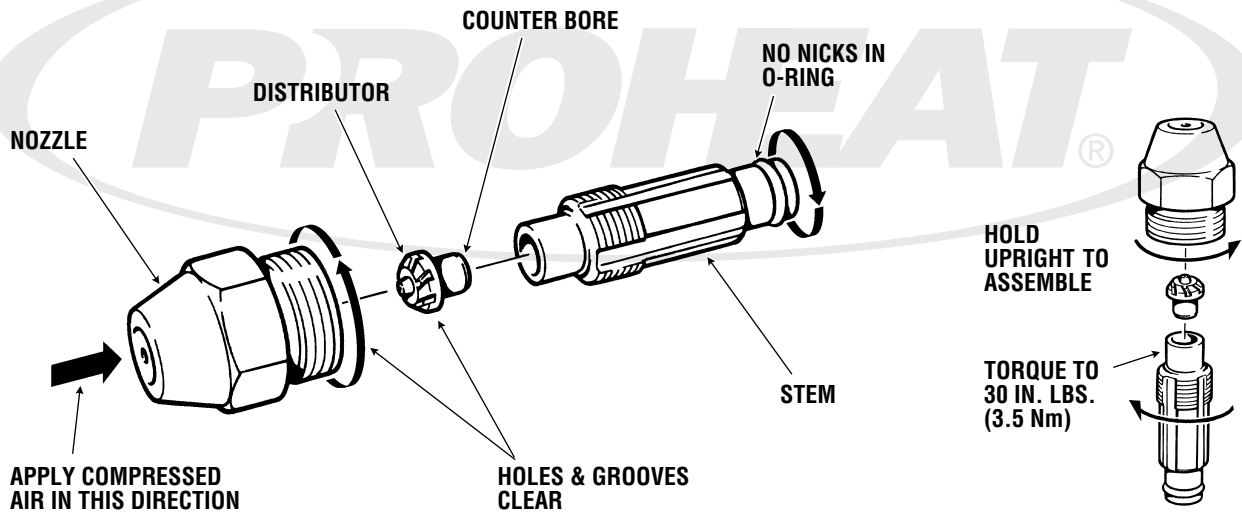

9 Compressor Air Filter

- Replace inlet air filter annually or more often if dusty conditions are encountered.

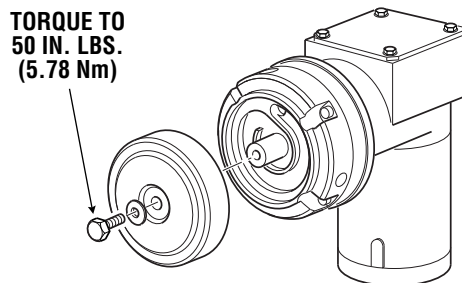

10 Electrical System

- Check the internal and the external wire harnesses for damage. Replace if required.
- Refer to Service Bulletin SB0049 'Annual Servicing Instructions for X45 Ignition Lead and Ignition Coil'.

11 Timer / Toggle Switch

- Check to see that both operate as described in the Operation Manual.

12 Air Pressure Check

- Please refer to the X45 service manual 925830 for further information.

**NOTE:
DIGITAL MANOMETER
PK0037 SHOWN**

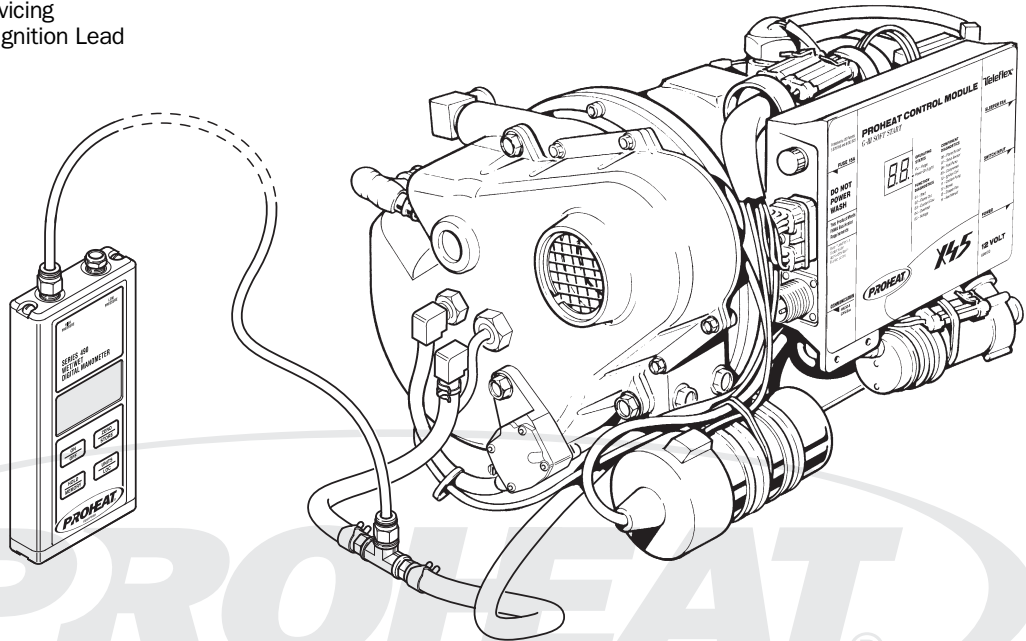

13 Operation Test

- Run the system for at least 15 minutes or until the heater cycles "OFF" and then "ON" again.
- Alternate the thermostat for the sleeper heater (if connected) between the lowest and highest settings to ensure that the sleeper heater fan cycles "ON" and "OFF".

Also available:

PK0069 Major Service Kit
 Rebuild Kits available:
 900316K Blower Fan Blade Kit
 865893K Coolant Pump Rebuild Kit
 954685K Compressor Rebuild Kit

Service Tools available:

952925K Remote On/Off Switch
 PK0037 Digital Manometer Air Gauge
 PK0060 Fuel Pressure Gauge

Replacement Parts

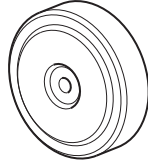
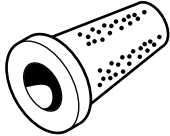
PART #	QTY	DESCRIPTION	
825730K	1	Air Filter, X45.	
880035K	1	Fuel Filter, X45	
PK0094	1	X45 Fall Service Kit includes: 1 x Air Filter 1 x Fuel Filter 2 x O-Ring	

NOTICE

Please refer to the X45 Parts Book at www.proheat.com